

BRASS FITTINGS



BRASS FITTINGS



BRASS NOZZLE ELBOW PG-FT-93



Technical Specification

1. Normal pressure: 16 bar
2. Working medium: water
3. Working Temperature: $0\text{ }^{\circ}\text{C} \leq t \leq 100\text{ }^{\circ}\text{C}$
4. Thread standard: ISO 228-1:2000
5. Surface finish: polishing & Chromed

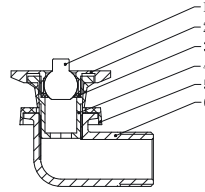

Material Specification

ITEM	PARTS	MATERIAL	Size	APPROX.W(gm)	⌀	⌀
1	Moving Ball	Brass	1/2"	110	48	192
2	Face	Brass				
3	O-Ring	NBR				
4	Nozzle	Brass				
5	Seal Cover	NBR				
6	Elbow	Brass				

BRASS FITTING PG-DIN-207 PLUS

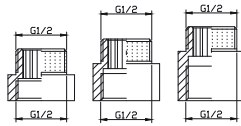

Specification	Length(mm)	APPROX.W(gm)	⌀	⌀
1/2" x 1/2"	10	33	60	600
	15	40	50	500
	20	48	40	400
	25	64	30	300
	30	75	25	250
	40	83	20	200
	50	110	20	200

BRASS FITTING PG-DIN-355

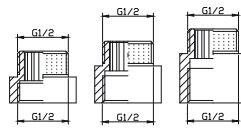

Specification	Length(mm)	APPROX.W(gm)	⌀	⌀
1/2" x 1/2"	10	35	60	600
	15	43	50	500
	20	52	40	400
	25	64	30	300
	30	75	25	250
	40	83	20	200
	50	110	20	200

BRASS FITTING PG-DIN-59

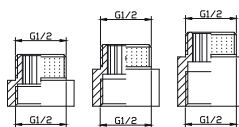

Specification	Length(mm)	APPROX.W(gm)	⌀	⌀
1/2" x 1/2"	10	42	60	600
	15	56	50	500
	20	72	40	400
	25	85	30	300
	30	100	25	250
	40	83	20	200
	50	110	20	200

BRASS FITTING PG-DIN-444

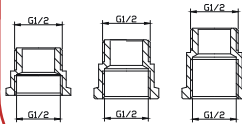

Specification	Length(mm)	APPROX.W(gm)	⌀	⌀
1/2" x 1/2"	10	34	60	600
	15	42	50	500
	20	50	40	400
	25	58	30	300
	30	65	25	250

BRASS FITTING PG-DIN-360

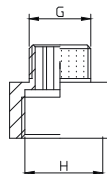

Specification	APPROX.W(gm)	⌀	⌀
3/8" x 1/2"	40	50	500
1/2" x 3/4"	53	40	400



BRASS FITTINGS



SANITARY HOSES DRAINERS HVAC FITTINGS BRASS FITTINGS CHECK VALVES ANGLE VALVES GAS VALVES BIBCOCKS & TAPS PPR VALVES & FITTINGS BALL VALVE

BRASS NIPPLE PG-NPL-86 / PG-NPL-87

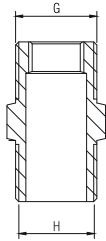

Specification	APPROX.W(gm)	⊞
PG-NPL-86		
1/4" X 1/4"	12	600
3/8" X 3/8"	25	500
1/2" X 1/2"	45	350
3/4" X 3/4"	80	200
PG-NPL-87		
3/8" X 1/2"	32	500
1/2" X 3/4"	65	300

BRASS FITTING PG-NPL-90

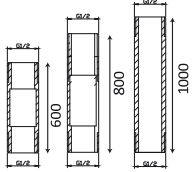

Specification	Length	APPROX.W(gm)	⊞
1/2" X 1/2"	60	61	240
	80	86	180
	100	123	120

S. CONNECTOR PG-FT-91

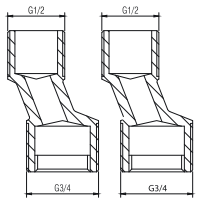

Specification	APPROX.W(gm)	⊞
1/2" X 3/4"	67	100 set

BRASS FITTING PG-FT-100

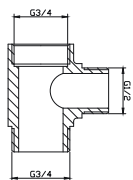

Specification	APPROX.W(gm)	⊞
3/4" M 1/2" M 3/4" F	110	140

BRASS FITTING PG-FT-101

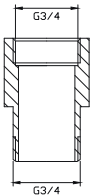

Specification	APPROX.W(gm)	⊞
3/4"	110	140

TANK NIPPLE PG-FT-201

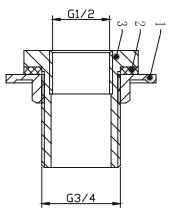

Specification	APPROX.W(gm)	⊞
1/2"	127	200
3/4"		
1"		
1 1/4"		
1 1/2"		



BRASS FITTINGS



SANITARY HOSES DRAINERS HVAC FITTINGS BRASS FITTINGS CHECK VALVES ANGLE VALVES GAS VALVES BIBCOCKS & TAPS PPR VALVES & FITTINGS BALL VALVE

**CP POSH
PG-FT-94**

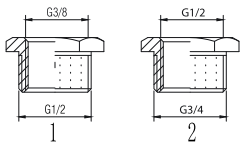

Specification	APPROX.W(gm)	☺
3/8" X 1/2"	18	450
1/2" X 1/4"	24	400
1/2" X 3/4"	31	400

**BRASS CAP (M)
PG-FT-96**

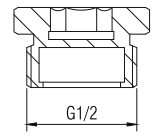

Specification	APPROX.W(gm)	☺
1/2"	25	450

**BRASS CAP (M)
PG-FT-97**

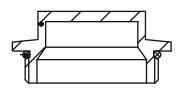

Specification	APPROX.W(gm)	☺
1/2"	24	675
3/4"	40	380
1"	60	200

**BRASS CAP (F)
PG-FT-97**

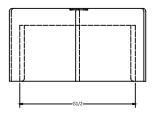

Specification	APPROX.W(gm)	☺
1/2"	24	450

**BRASS T SHAPE
PG-FT-87**

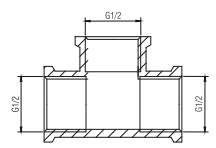

Specification	APPROX.W(gm)	☺ / ☺
1/2"	95	48/192

**BRASS ELBOW
PG-FT-88**

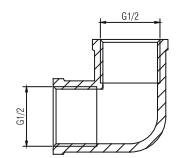

Specification	APPROX.W(gm)	☺ / ☺
1/2"	80	60/240

**BRASS MALE ELBOW
PG-FT-89**

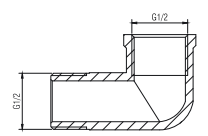

Specification	APPROX.W(gm)	☺ / ☺
1/2"	88	60/240

**BRASS DOUBLE MALE ELBOW
PG-FT-95**

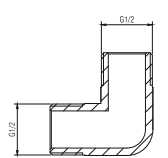

Specification	APPROX.W(gm)	☺ / ☺
1/2"	92	60/240

**BRASS FEMALE JOINT
PG-FT-90**

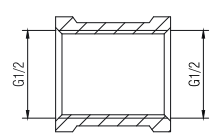

Specification	APPROX.W(gm)	☺ / ☺
1/2"	47	75/300

